

STAINLESS STEEL 316L PRESS FIT FITTINGS (M PROFILE)

COMPLY WITH BSEN1254-2:1998
AS 3688:2005
AS/NZS 4020:2005
ASTM E1086:2014
SS 375:2015
SS 270:2015

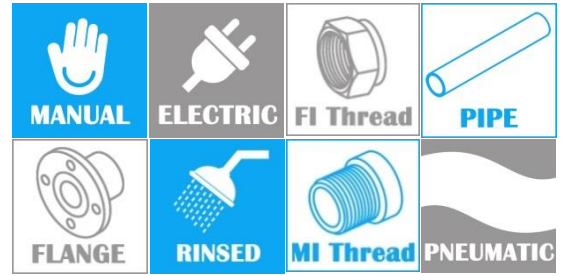

FI SOCKET

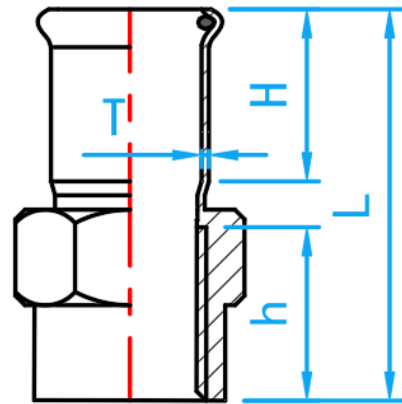

CROSS SECTIONAL VIEW

DIMENSIONS

SKU	SIZE (mm x inch)	L (mm)	H (mm)	h (mm)	T (mm)	WEIGHT (kg)	PCS/CTN
SS316LPFNFA01515	15×1/2" BSP	51	20	15.5	1.5	0.050	300
SS316LPFNFA02015	22×1/2" BSP	50	20	15	1.5	0.064	240
SS316LPFNFA02020	22×3/4" BSP	50	21	16	1.5	0.076	170
SS316LPFNFA02525	28×1" BSP	57	23	20	1.5	0.134	120
SS316LPFNFA03515	35×1/2" BSP	64	26	15.5	1.5	0.130	80
SS316LPFNFA03525	35×1" BSP	64	26	20	1.5	0.180	80
SS316LPFNFA03535	35×1 1/4" BSP	64	26	22	1.5	0.168	75
SS316LPFNFA04215	42×1/2" BSP	80	31	25	1.5	0.134	120
SS316LPFNFA04242	42×1 1/2" BSP	71	31	25	1.5	0.210	60
SS316LPFNFA04250	42×2" BSP	98	31	25	1.5	0.318	38
SS316LPFNFA05015	54×1/2" BSP	86	36	15.5	1.5	0.170	70
SS316LPFNFA05050	54×2" BSP	82	50	28	1.5	0.335	36
SS316LPFNFA06515	76×1/2" BSP	111	50	15.5	2.0	0.310	28
SS316LPFNFA06550	67×2" BSP	115	50	25.0	1.5	0.435	15
SS316LPFNFA06565	67×2 1/2" BSP	115	50	28	2.0	0.570	15
SS316LPFNFA08015	76×1/2" BSP	120	51	15.5	2.0	0.405	24
SS316LPFNFA10015	108×1/2" BSP	153	75	15.5	2.0	0.810	10